



The Federation of The Downs & Northbourne Church of England Primary Schools



Chair of Governors: Dr A Eyden
Vice Chair of Governors: Rev D Ridley

"if you have faith as small as a mustard seed...nothing will be impossible."
(Matthew: 17 v20)

Thursday 6th January

Paper Home Learning Packs & Reading Books & How to upload work to your teacher via Purple Mash

Dear Parents / Carers,

Now we are a few days into lockdown, I think the enormity of events are really sinking in. This week has been one of the most disorienting school weeks I can remember. I'm sure it is the same for many of you!

Paper Home Learning Packs to complement the online Remote Learning

We have moved quickly to ensure that the Remote Learning resources on the school website are in place and accessible for the children. However, we are very aware that not all children will learn in the same way, and sitting at a screen all day is neither healthy nor practical. Therefore, we are currently producing another batch of paper home learning packs for all of our pupils.

These paper home learning packs will contain core learning activities that compliment and support the planned remote learning on our website. Pupils will have the choice of moving between the online and paper learning resources, in order to support their learning in the best way possible.

They will be ready for collection from Monday 11th from the school office. Please do not all rush on Monday morning, you can collect them at your own convenience. Please wear a mask and do not enter the school office area if another adult is already there.

Reading books –Returning old ones and collecting new ones

For our youngest pupils in Willow Class, Beech Class and Maple Class we will also include some phonics and reading scheme books in their paper home learning pack, to help them continue with their phonics and reading fluency.

**Please return any reading books you currently have at home when you collect your paper packs on Monday. Older children who are still reading through a longer school book do not have to return them if they don't want to.*

Sending completed work to the teacher – Purple Mash

Any learning completed on paper can be kept, ready for their return to school. Most of the packs will have an exercise book or folder in which the pupils can record their work. Pupils may also choose to send copies of their completed work to their teacher via the Purple Mash portal. Anything can be sent to their teachers via Purple Mash, e.g photographs, pictures, Word documents, Powerpoints, videos, etc. A reminder of your child's login for Purple Mash will be included in the paper home learning packs as well as being sent out to you electronically. The next page has a guide showing you how to use Purple Mash to send work to your teacher.



Instructions on how to upload work to your teacher via Purple Mash

Here is the link for the Purple Mash website:

<https://www.purplemash.com/#tab/pm-home>

The home page should look like the screen shot below. Click on the 'Work' tab to gain access to the class work area.

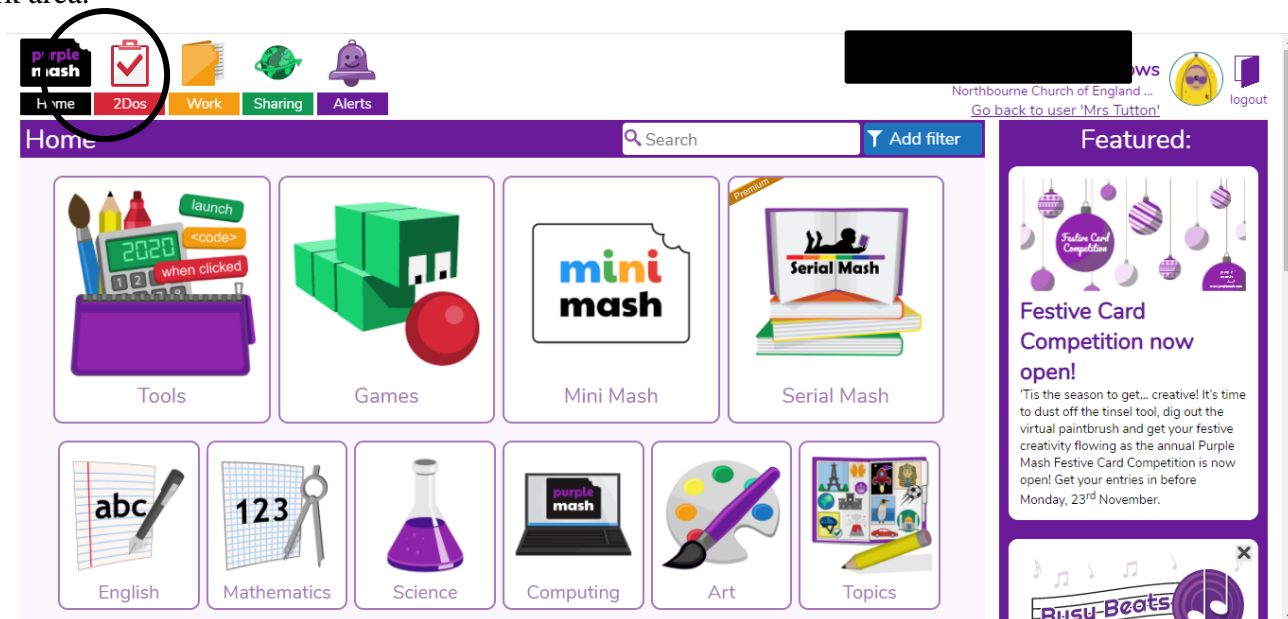

This area also includes an area called 'My Work'. If you click on this and then find the purple tab 'Upload', you will see this screen:

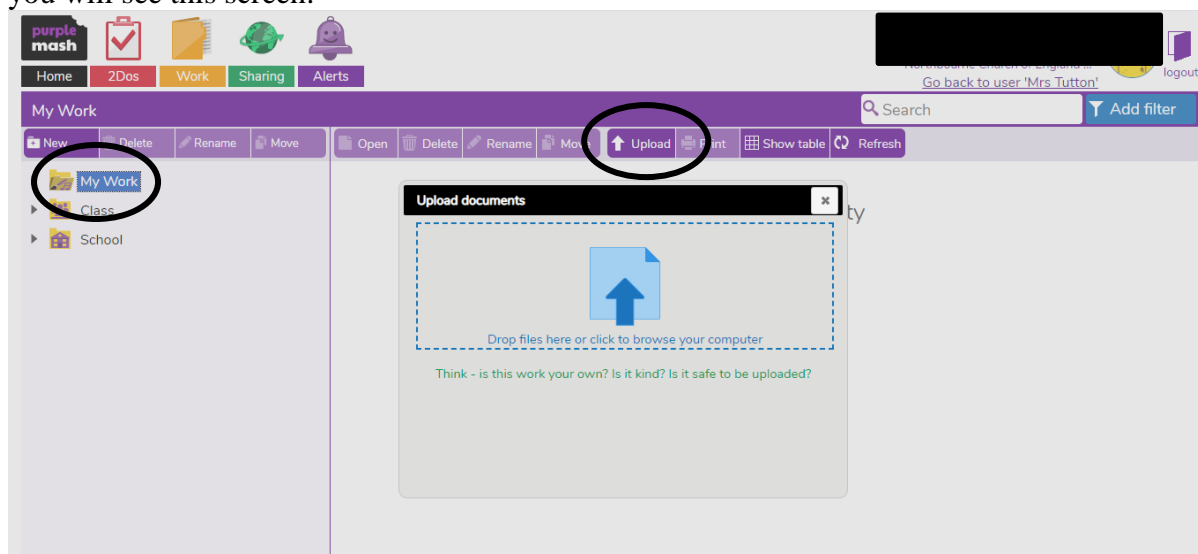

You can then browse your computer to find the file you want to upload, click on it to add it to your work folder. The document you attach will then be saved and the teacher can access it – and comment on it via Purple Mash as well.

Remember, the Pupil Zone area on the school website has the links to “*Purple Mash*”, “*Language Angels*”, “*Mathletics*” and “*Times Tables Rockstars*” as well as a list of further sites for the children to explore.

[Northbourne CE Primary School - Home \(northbourne-cep.kent.sch.uk\)](http://northbourne-cep.kent.sch.uk)

